

Reliance® Electric Tankless Water Heaters are compact, easy to install, and offer instant and continuous hot water when sized appropriately.



- 5-Year Limited Warranty Heating Chamber
1-Year Limited Parts Warranty†
- Available in 12.2kW - 32kW
- Works with low flow fixtures activates at 0.25 GPM
- Scale Reduction Technology extends heater life
- Nearly silent operation
- Easily Installs – wall mount
Compact design ideal for tight spaces
3/4" NPT water connections
- Dry-Fire protection - guards against element failure
Internal air bypass fills chamber
Air infiltration monitoring with temporary shutdown

- Advanced electronic control system
Provides consistent temperature output even as demand varies
Guards against light flicker/dimming
Self-Diagnostics with leak detection shutdown
Easy to use user interface with LCD display*
Visually displays current temperature, setpoint, operational and diagnostics information*
- Ease of maintenance
No moving parts
Standard tank-type elements can be replaced with unit in place

†For complete information consult written warranty
*2- and 4-element models



Your neighborhood water heater source.





4 Element, 4 Chamber (R4MX, R4LX)

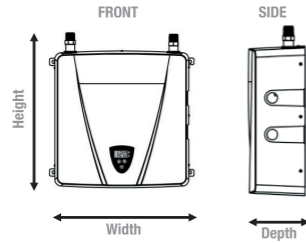

Model Number	Total Wattage (kW)	# Elements x kW Each	Voltage Single Phase	Full Load Amperage	Recommended # of Breakers & Rating	Recommended Wire Size	Activation GPM	Width (inches)	Height (inches)	Depth (inches)	Approx. Shipping Weight (lbs)
4 Element, 4 Chamber Models											
R4MX-320E	32	4 x 8 kW	240	133.33	2 x 70	6	0.25	17	18-1/8	6-1/8	22
R4LX-280E	28	4 x 7 kW	240	116.67	2 x 60	6	0.25	17	18-1/8	6-1/8	22
R4LX-280X	28	4 x 7 kW	208	134.62	2 x 70	6	0.25	17	18-1/8	6-1/8	22
R4LX-240E	24	4 x 6 kW	240	100.00	2 x 60	6	0.25	17	18-1/8	6-1/8	22
R4LX-220E	22	4 x 5.5 kW	240	91.67	2 x 50	6	0.25	17	18-1/8	6-1/8	22
R4LX-180E	18	4 x 4.5 kW	240	75.00	2 x 40	8	0.25	17	18-1/8	6-1/8	22

Model Number	Southern Zone		Central Zone		Northern Zone	
	Sinks	Showers	Sinks	Showers	Sinks	Showers
4 Element, 4 Chamber Models						
R4MX-320E	1	3	2	2	0	2
R4LX-280E	0	3	1	2	2	1
R4LX-280X	0	3	1	2	2	1
R4LX-240E	2	2	0	2	1	1
R4LX-220E	1	2	2	1	1	1
R4LX-180E	0	2	1	1	0	1

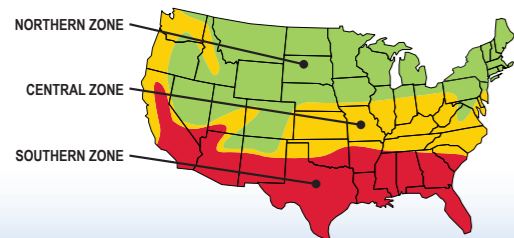

GPM @ Temp Rise °F Shown - Two and Four Chamber Models														
Wattage	20°	25°	30°	35°	40°	45°	50°	55°	60°	65°	70°	75°	80°	
32 kW	10.9	8.7	7.3	6.2	5.5	4.9	4.4	4.0	3.6	3.4	3.1	2.9	2.7	
28 kW	9.6	7.6	6.4	5.5	4.8	4.2	3.8	3.5	3.2	2.9	2.7	2.5	2.4	
24 kW	8.2	6.6	5.5	4.7	4.1	3.6	3.3	3.0	2.7	2.5	2.3	2.2	2.0	
22 kW	7.5	6.0	5.0	4.3	3.8	3.3	3.0	2.7	2.5	2.3	2.1	2.0	1.9	
18 kW	6.1	4.9	4.1	3.5	3.1	2.7	2.5	2.2	2.0	1.9	1.8	1.6	1.5	

FOR COMPLETE INFORMATION CONSULT WRITTEN WARRANTY.



2 Element, 2 Chamber (R2VX)

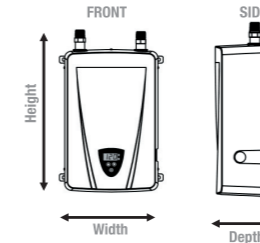

Model Number	Total Wattage (kW)	# Elements x kW Each	Voltage Single Phase	Full Load Amperage	Recommended # of Breakers & Rating	Recommended Wire Size	Activation GPM	Width (inches)	Height (inches)	Depth (inches)	Approx. Shipping Weight (lbs)
2 Element, 2 Chamber Models											
R2VX-180E	18	2 x 9 kW	240	75.00	2 x 40	8	0.25	11-1/2	17-3/4	6-1/8	15
R2VX-160E	16	2 x 8 kW	240	66.67	2 x 40	8	0.25	11-1/2	17-3/4	6-1/8	15
R2VX-140E	14	2 x 7 kW	240	58.33	1 x 60	6	0.25	11-1/2	17-3/4	6-1/8	15
R2VX-140X	14	2 x 7 kW	208	67.31	2 x 40	8	0.25	11-1/2	17-3/4	6-1/8	15

Model Number	Southern Zone		Central Zone		Northern Zone	
	Sinks	Showers	Sinks	Showers	Sinks	Showers
2 Element, 2 Chamber Models						
R2VX-180E	0	2	1	1	0	1
R2VX-160E	2	1	1	1	0	1
R2VX-140E	1	1	0	1	2	0
R2VX-140X	1	1	0	1	2	0

GPM @ Temp Rise °F Shown - Two and Four Chamber Models														
Wattage	20°	25°	30°	35°	40°	45°	50°	55°	60°	65°	70°	75°	80°	
18 kW	6.1	4.9	4.1	3.5	3.1	2.7	2.5	2.2	2.0	1.9	1.8	1.6	1.5	
16 kW	5.5	4.4	3.6	3.1	2.7	2.4	2.2	2.0	1.8	1.7	1.6	1.5	1.4	
14 kW	4.8	3.8	3.2	2.7	2.4	2.1	1.9	1.7	1.6	1.5	1.4	1.3	1.2	

FOR COMPLETE INFORMATION CONSULT WRITTEN WARRANTY.

